

COMPANY: Carbon Coal and Clay Co.  
 MINE: Carbon Mines  
 COUNTY & DISTRICT: Cumberland  
 LEGAL DISTRICT: 21 N. & 7 E. 15, 33  
 HELD BY: D. L. V. COOK  
 MAP DATED: July 6, 1916. PAID UP DATE: 4/27/17  
 COMPILED BY: [unclear]  
 ROLL NO. 52 INDEX PAGE 1203  
 REMARKS: Blueprint

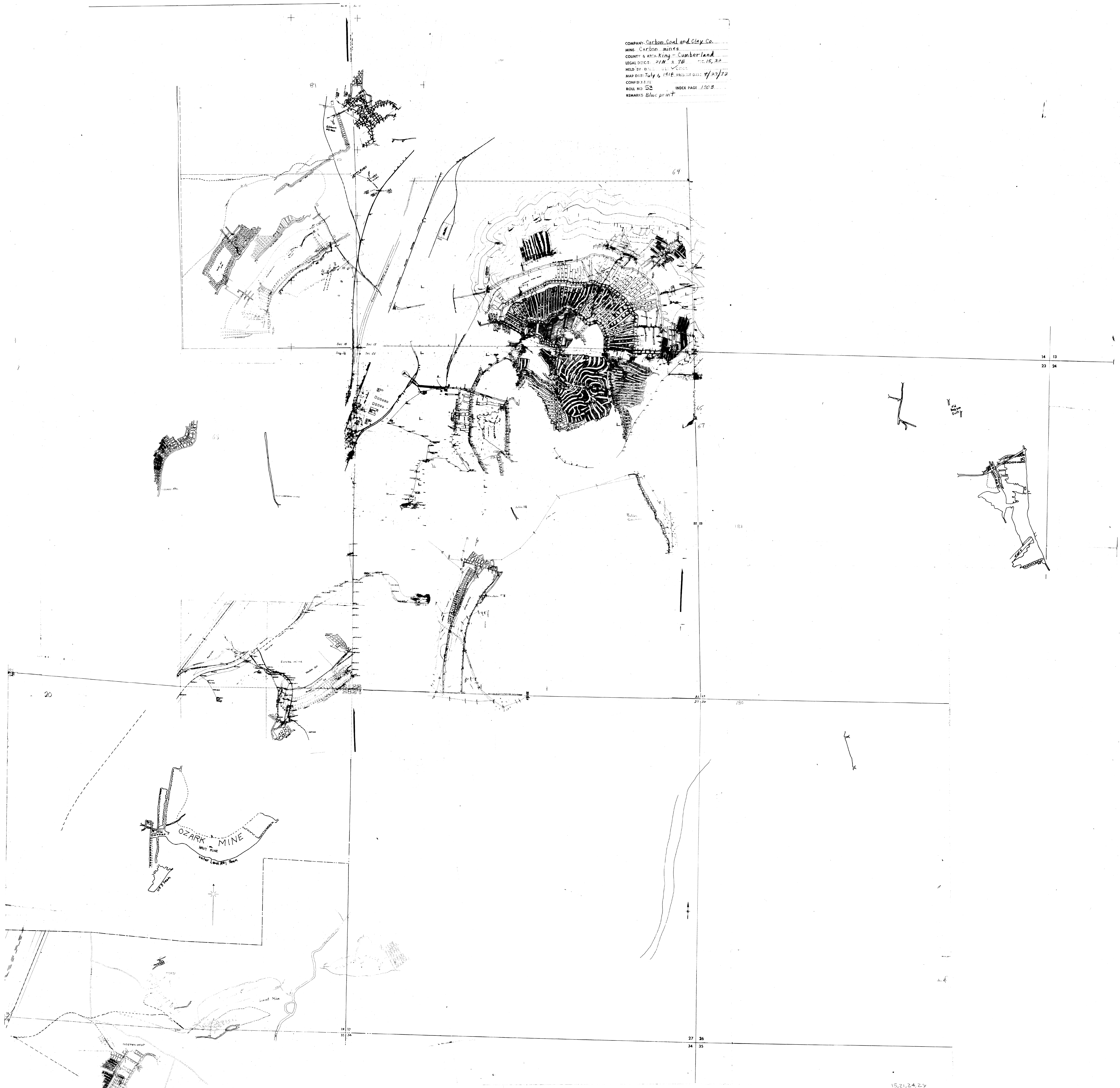

KING COUNTY - Cumberland area:

Index no.	Mine	Areal coverage and scale
*	Roides Carbon	Secs. 14-16, 21-23,
K99	Carbon	27, 28, 33
K97	Carbon Fuel Co. mine no. 4	(21-71)
K99	Daly	
K96	Eureka	scale: 1:4800
*	Fibbons no. 3	
K93	Independent	
*	Lizard Mt.	
K98	New Carbon seam	* mine appears only
K101	Occidental	on this composite
K95	Navy (Ozark)	
K102	Fig 6 Mine	
K94	Sunset	

15,21,24,27